

Wireless Radio Control Solutions for Equipment Movement and Operations



PRODUCT SPECIFICATION SHEET

CAN-6 RECEIVER

The CAN-6 receiver makes adding remote control to hydraulically “can-bus” controlled machinery simple and easy. Enrange’s CAN-6 receiver allows you to tap on to most CAN-bus systems, especially a standard J1939 communication CAN-bus system. It is also compatible with Parker’s TOC2 IQAN modules. The small compact design is rugged enough to handle outdoor environments, and the quick response allows for precise control, without the latency found in other radio control systems. The CAN-6 has eight analog outputs, eight digital outputs and CAN inputs. You never have to worry about interference with the choice of 400Mhz or 900Mhz RF channels. So the next time you need a radio control for your hydraulic equipment, select the R-Link series of receivers for your project.

Specifications

Size:	(L x W x D) 5.7" x 4.6" x 1.4"
Mounting:	(2) DIA. 9/32 holes
Operating frequency:	900Mhz and 400Mhz bands
Diagnostics:	LED diagnostics or back to controller display
Input Voltage:	12-48VDC
Enclosure:	Sealed to IP67 specification
Material:	Nylon 6/6
Analog outputs:	8 (0-5VDC, 0-10VDC or 3-6-9VDC)
Relay outputs:	8 digital (1 reserved for E-stop)
Relay rating:	3A @ 12VDC continuous
Inputs:	CAN inputs
Temperature:	—10 to 70 celsius

Features

- Easily integrated into CAN based products and products with J1939 communications
- Can be connected with Parker Hydraulics TOC 2 IQAN units, or other devices that require an analog voltage input.
- Designed for outdoor use. Sealed to IP67 specifications
- 8 analog outputs (0-5-VDC, 0-10VDC, or 3-6-9VDC)
- 8 digital (on/off) outputs (dedicated E-stop, 3 extra)
- Power 12VDC - 48VDC
- Small, rugged compact design
- Requires no FCC site license



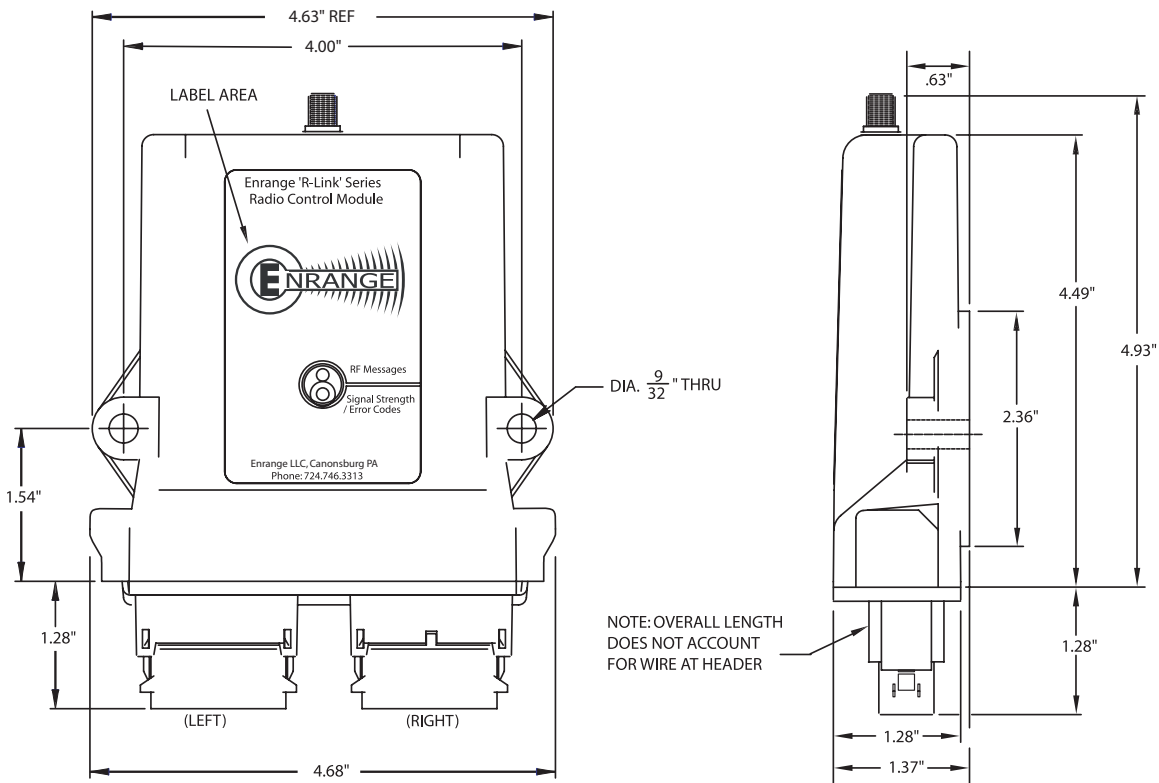

TYPICAL RECEIVER LAYOUT

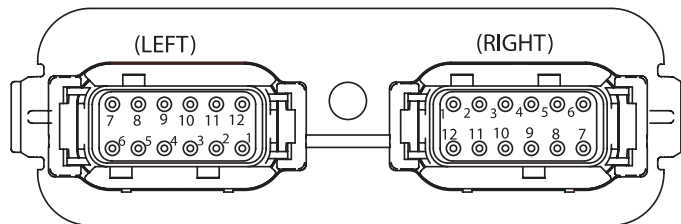

LEFT CONNECTOR CONNECTION DIAGRAM		
PIN	FUNCTION	DESCRIPTION
5	Output 1	Digital Output 1
8	Output 2	Digital Output 2
4	Output 3	Digital Output 3
9	Output 4	Digital Output 4
10	Output 5	Digital Output 5
3	Output 6	Digital Output 6
11	Output 7	Digital Output 7
12	Output 8	Reserved as radio E-stop
7	+VBatt	+12 to 24 VDC Power
6	-VBatt	Common
1	CANL	J1939 CANL
2	CANH	J1939 CANH

RIGHT CONNECTOR CONNECTION DIAGRAM		
PIN	FUNCTION	DESCRIPTION
6	Output 9	Analog Output 1 (0-10VDC)
5	Output 10	Analog Output 2 (0-10VDC)
3	Output 11	Analog Output 3 (0-10VDC)
4	Output 12	Analog Output 4 (0-10VDC)
10	Output 13	Analog Output 5 (0-10VDC)
11	Output 14	Analog Output 6 (0-10VDC)
2	Output 15	Analog Output 7 (0-10VDC)
9	Output 16	Analog Output 8 (0-10VDC)
7	CANL	J1939 CANL
8	CANH	J1939 CANH
1	+VBatt	+12 to 24 VDC
12	-VBatt	Common



MAGNETEK
MATERIAL HANDLING

N49 W13650 Campbell Drive
Menomonee Falls, WI 53051
p 800.288.8178
f 262.783.3510

www.magnetekmh.com

2610 Dunwin Drive
Mississauga, Ontario
L5L 1J5 CANADA
p 800.792.7253
f 905.828.5707



#5 Four Coins Drive
Canonsburg, PA 15317-1751
p 724.746.3313
f 724.746.3379